

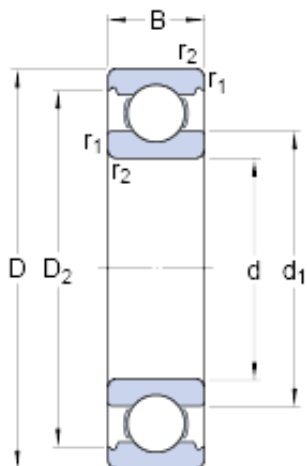

NTN BEARING MANUFACTURING DE MEXICO,S...



20 mm x 42 mm x 8 mm skf 16004 Deep groove ball bearings

Bearing No. 16004

16004 Bearing 2D drawings and 3D CAD models

Size	42x20x8 mm
Bore Diameter	42 mm
Outer Diameter	20 mm
Width	8 mm
d	20 mm
D	42 mm
B	8 mm
d ₁	27.25 mm
D ₂	37.19 mm
r _{1,2} - min.	0.3 mm
d _a - min.	22 mm
D _a - max.	40 mm
r _a - max.	0.3 mm
Basic dynamic load rating - C	7.3 kN
Basic static load rating - C ₀	4 kN
Fatigue load limit - P _u	0.173 kN
Reference speed	38000 r/min
Limiting speed	24000 r/min
Calculation factor - k _r	0.02
Calculation factor - f ₀	15
Category	Single Row Ball Bearings
Inventory	0.0
Manufacturer Name	SKF
Minimum Buy Quantity	N/A



NTN BEARING MANUFACTURING DE MEXICO,S...

Weight / Kilogram	0.052
EAN	7316577015839
Product Group	B00308
Enclosure	Open
Precision Class	ABEC 1 ISO P0
Maximum Capacity / Filling Slot	No
Rolling Element	Ball Bearing
Snap Ring	No
Internal Special Features	No
Cage Material	Steel
Internal Clearance	C0-Medium
Inch - Metric	Metric
Long Description	20MM Bore; 42MM Outside Diameter; 8MM Outer Race Diameter; Open; Ball Bearing; ABEC 1 ISO P0; No Filling Slot; No Snap Ring; No Internal Special Features
Category	Single Row Ball Bearing
UNSPSC	31171504
Harmonized Tariff Code	8482.10.50.68
Noun	Bearing
Keyword String	Ball
Manufacturer URL	http://www.skf.com
Manufacturer Item Number	16004
Weight / LBS	0.115
Bore	0.787 Inch 20 Millimeter
Outer Race Width	0.315 Inch 8 Millimeter
Outside Diameter	1.654 Inch 42 Millimeter
d ₁	27.25 mm
d _a min.	22 mm
D _a max.	40 mm



NTN BEARING MANUFACTURING DE MEXICO,S...

r_a max.	0.3 mm
Basic dynamic load rating C	7.28 kN
Basic static load rating C_0	4.05 kN
Fatigue load limit P_u	0.173 kN
Calculation factor k_r	0.02
Calculation factor f_0	14.9
Mass bearing	0.051 kg